

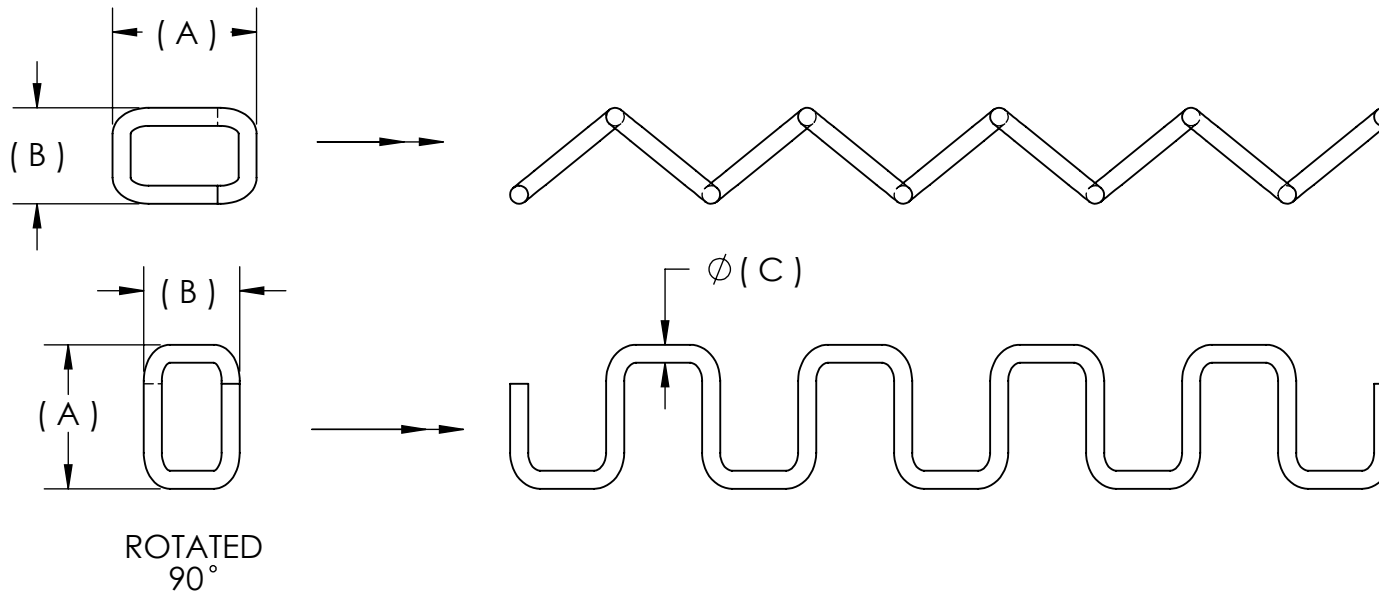

ANCHOR DIMENSION TABLE

A=	B=	C=	D=	E=	F=	G=	H=	I=	J=	K=

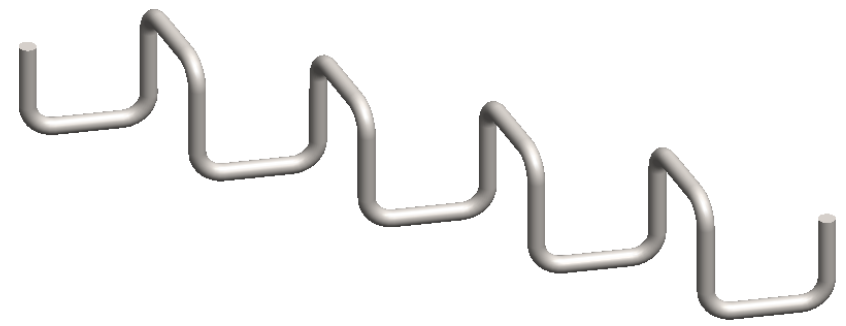

NOTE:
THIS SYSTEM MAY BE INSTALLED TWO WAYS TO ACCOMODATE
VARIOUS LINING THICKNESSES (AS SHOWN IN END VIEW SECTIONS)

SUPPLIED IN 12" AND 18" LENGTHS

HL-401

www.hanlock.com